

Gel battery shows some distinctive advantages over flooded battery or AGM battery, such as super thermal stability, high deep discharge capability, good recovery from deep discharge, even if the battery is left discharged for three days, it will recover to 100% of capacity. With the above-mentioned advantages, the gel battery has long service life, specially suitable for motive power applications, such as golf trailer, sruubber, folklift, etc.



Battery Construction

Component	Positive plate	Negative plate	Container	Cover	Safety valve	Terminal	Separator	Electrolyte
Raw material	Lead dioxide	Lead	ABS	ABS	Rubber	Copper	Fiberglass	Colloidal silicon

General Feature

- Micro millimeter SiO₂ and H₂SO₄ technology for Efficient gas recombination of up to 99% and Freedom from electrolyte maintenance or water adding.
- Not restricted for air transport-complies with IATA/ICAO Special Provision A67.
- UL-recognized component.
- Can be mounted in any orientation.
- Computer designed lead, calcium tin alloy grid for high power density.
- Long service life, float or cyclic applications.
- Maintenance-free operation.
- Low self discharge.

Performance Characteristics

Capacity 77°F(25°C)	20 hour rate (6.0A , 10.5V)	120Ah
	10 hour rate (11.5 A ,10.5V)	115Ah
	5 hour rate (20.5A、 10.5V)	102.5Ah
	1 hour rate (76A、 9.6V)	76Ah
Internal Resistance	Full charged Battery77°F(25°C):5.5mΩ	
Operating Temperature Range	Discharge: -20~60°C	
	Charge: -10~60°C	
	Storage: -20~60°C	
Self-Discharge 3% of capacity declined per month at 20°C(average)		
Max. discharge current77°F(25°C): 1200A(5S)		
Charge (Constant Voltage)	Float: 13.5 ~13.8 V/77 ° F(25°C)	
	Cycle:14.4 ~14.7V/77°F(25°C)	
	Max. Current: 30A	

SPECIFICATION

Nominal voltage 12V
 Number of cell 6
 Length(mm/inch) 410/16.1
 Width(mm/inch) 176/6.93
 Height(mm/inch) 227/8.94
 Total Height(mm/inch) 227/8.94
 Approx. Weight (kg/lbs) 33/72.7

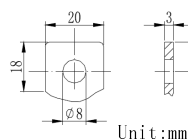
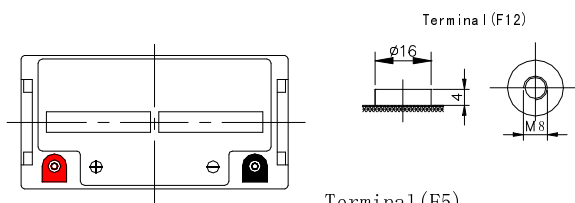
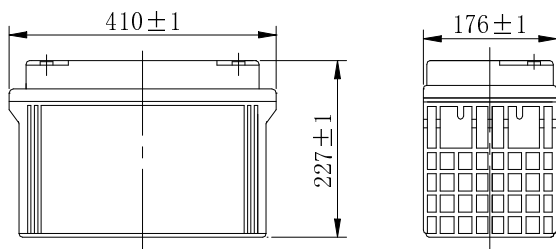

Unit:mm

Discharge Constant Current (Amperes at 77° F 25 °C)

End Point Volts/Cell	5min	10min	15min	30min	1h	3h	5h	10h	20h
1.60V	350	265	202	125	76.0	32.8	22.0	11.7	6.12
1.65V	332	253	194	120	73.0	32.2	21.6	11.6	6.10
1.70V	312	239	184	114	69.5	31.0	21.1	11.5	6.05
1.75V	290	224	174	108	68.0	30.7	20.5	11.5	6.00
1.80V	265	206	162	100	66.0	29.7	19.8	10.8	5.90

Discharge Constant Power (watts at 77° F 25 °C)

End Point Volts/Cell	5min	10min	15min	30min	45min	1h	2h	3h	5h
1.60V	600	450	380	230	180	143	78.0	58.1	40.8
1.65V	568	428	365	223	176	141	76.5	57.2	40.1
1.70V	533	403	347	213	170	139	74.5	56.0	39.3
1.75V	505	375	327	203	164	136	72.5	54.7	38.5
1.80V	473	345	305	190	156	132	70.0	53.2	37.5

(Note)The above characteristics data are average values obtained Within three charge/discharge cycles not the minimum values.

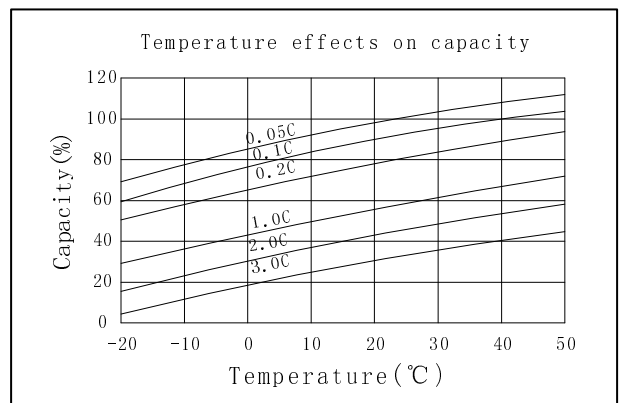
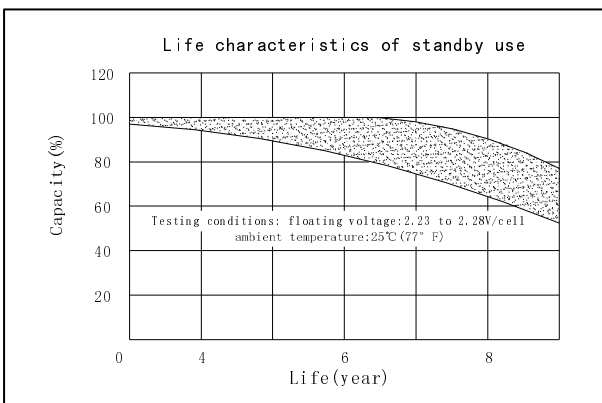
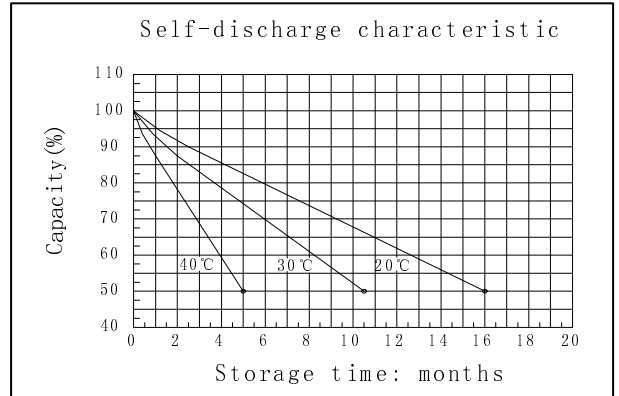
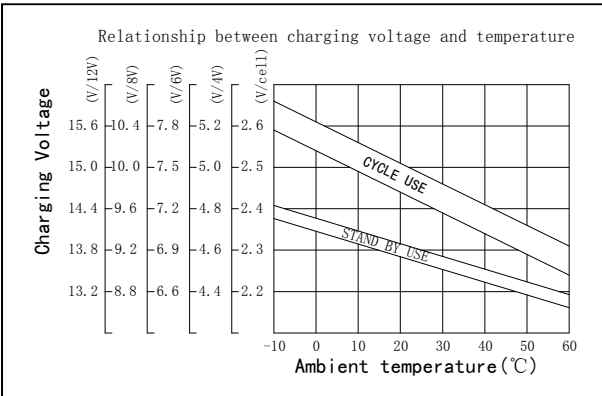
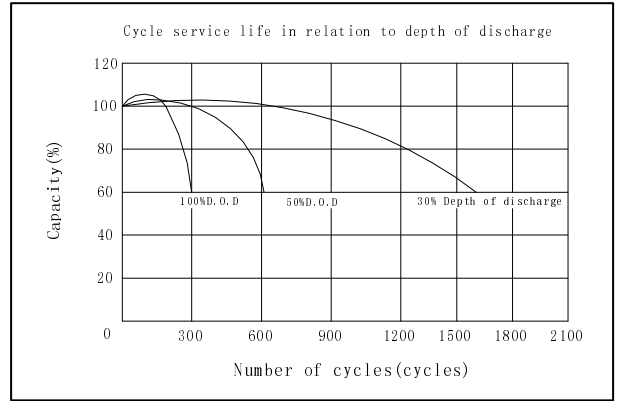
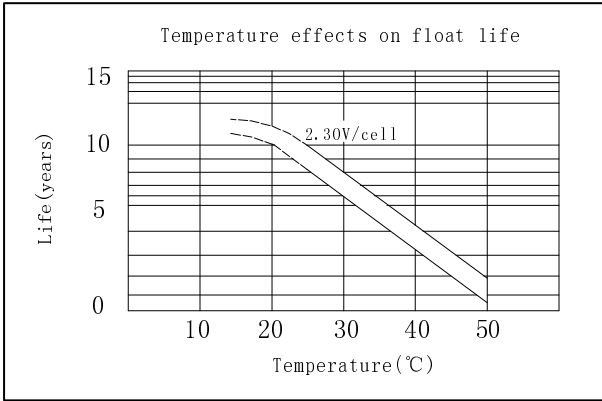
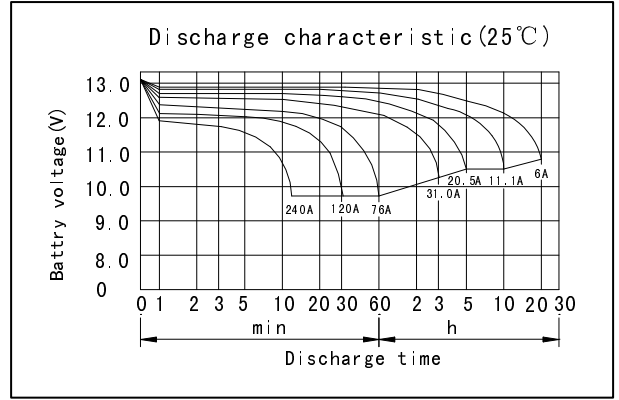
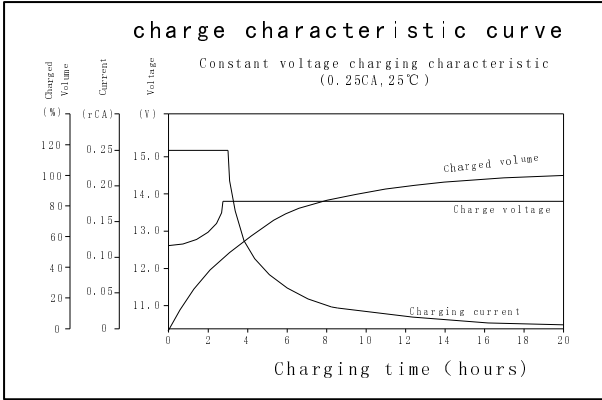

GREAT POWER BATTERY TECHNOLOGY CO.,LTD

Address: Longguan 1st Road, LongHua Town, BaoAn District, Shenzhen, China.

TEL: 86-755-2900 8403 Fax: 86-755-3386 3366

Email: info@greatpowerbattery.com Http:// www.greatpowerbattery.com

