

Gel battery shows some distinctive advantages over flooded battery or AGM battery, such as super thermal stability, high deep discharge capability, good recovery from deep discharge, even if the battery is left discharged for three days, it will recover to 100% of capacity. With the above-mentioned advantages, the gel battery has long service life, specially suitable for motive power applications, such as golf trailer, srubber, folklift, etc.



## Battery Construction

Component	Positive plate	Negative plate	Container	Cover	Safety valve	Terminal	Separator	Electrolyte
Raw material	Lead dioxide	Lead	ABS	ABS	Rubber	Copper	Fiberglass	Colloidal silicon

## General Feature

- Micro millimeter SiO<sub>2</sub> and H<sub>2</sub>SO<sub>4</sub> technology for Efficient gas recombination of up to 99% and Freedom from electrolyte maintenance or water adding.
- Not restricted for air transport-complies with IATA/ICAO Special Provision A67.
- UL-recognized component.
- Can be mounted in any orientation.
- Computer designed lead, calcium tin alloy grid for high power density.
- Long service life, float or cyclic applications.
- Maintenance-free operation.
- Low self discharge.

## SPECIFICATION

Nominal voltage ..... 12V  
 Number of cell ..... 6  
 Length(mm/inch) ..... 482/19.0  
 Width(mm/inch) ..... 170/6.69  
 Height(mm/inch) ..... 242/9.53  
 Total Height(mm/inch) ..... 242/9.53  
 Approx. Weight(kg/lbs) ..... 43/94.7

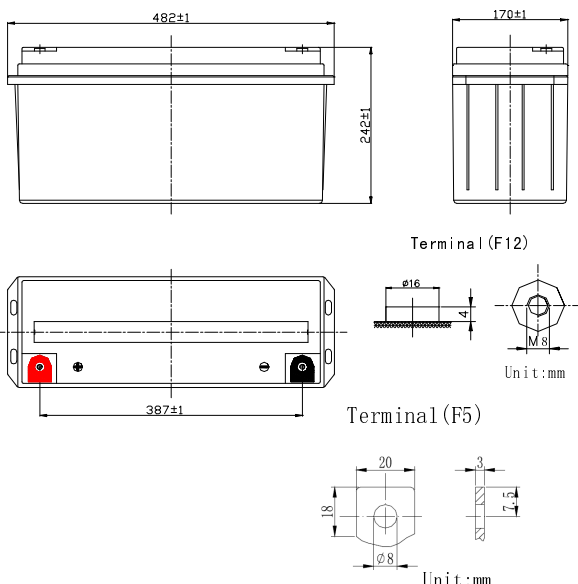

## Performance Characteristics

Capacity 77°F(25°C)	20 hour rate (7.5A 、 10.8V)	150Ah
	10 hour rate (14.5A、10.8V)	145Ah
	5 hour rate (26.0A 、 10.5V)	130Ah
	1 hour rate (95A、 9.6V)	95Ah
Internal Resistance	Full charged Battery77°F(25°C):4.8mΩ	
Operating Temperature Range	Discharge: -20~60°C	
	Charge: -10~60°C	
	Storage: -20~60°C	
Self-Discharge 3% of capacity declined per month at 20°C(average)		
Max. discharge current77°F(25°C): 1500A(5S)		
Charge (Constant Voltage)	Float: 13.5 ~13.8 V/77 ° F(25°C)	
	Cycle:14.4 ~14.7 V/77°F(25°C) Max. Current: 37.5A	

Discharge Constant Current (Amperes at 77°F25°C)

End Point Volts/Cell	5min	10min	15min	30min	1h	3h	5h	10h	20h
1.60V	445	347	282	163	95.0	40.1	28.1	15.1	7.73
1.65V	415	327	267	158	94.0	39.4	27.6	15.0	7.65
1.70V	384	306	253	153	93.0	38.5	27.1	15.0	7.60
1.75V	352	286	239	147	91.0	38.0	26.0	14.5	7.55
1.80V	317	263	226	144	89.0	37.4	26.0	14.2	7.50

Discharge Constant Power (watts at 77° F 25°C)

End Point Volts/Cell	5min	10min	15min	30min	45min	1h	2h	3h	5h
1.60V	765	609	501	325	221	201	112	78.0	53.5
1.65V	734	579	483	315	216	198	110	77.1	53.2
1.70V	686	548	465	306	211	195	108	76.2	52.8
1.75V	638	519	446	296	206	190	106	75.3	52.5
1.80V	591	487	425	286	202	184	105	74.0	52.0

(Note)The above characteristics data are average values obtained Within three charge/discharge cycles not the minimum values.

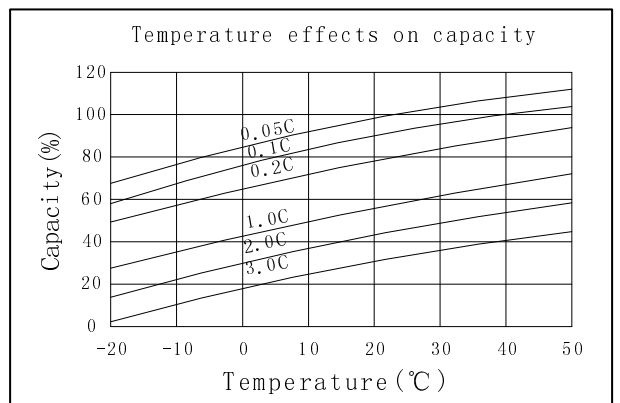
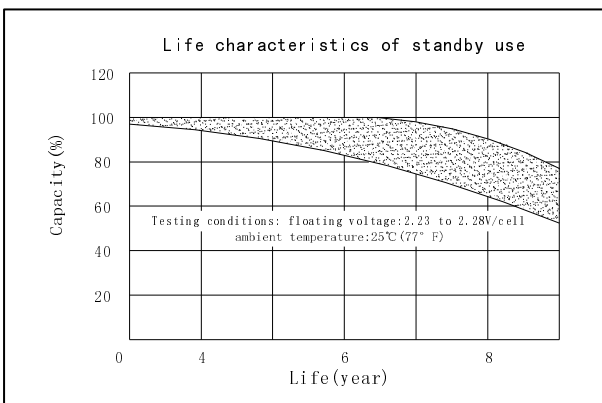
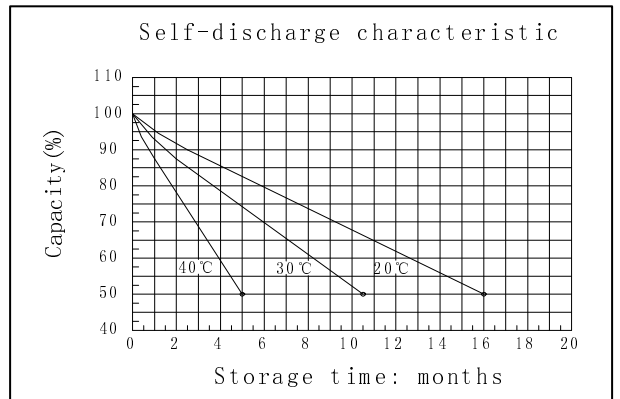
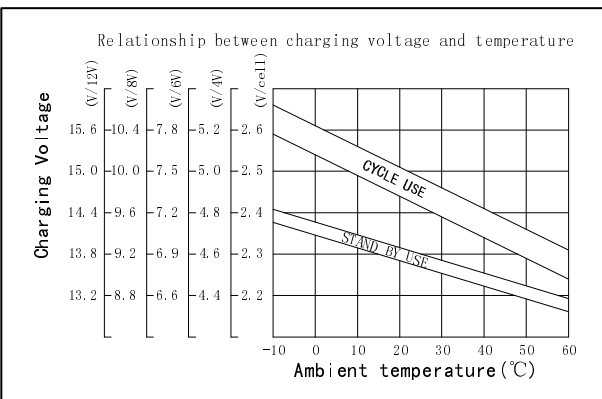
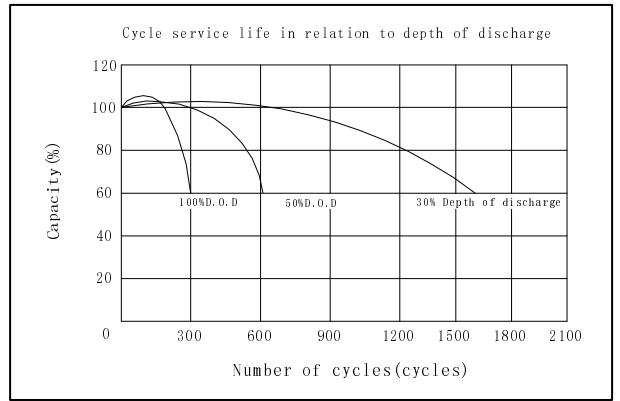
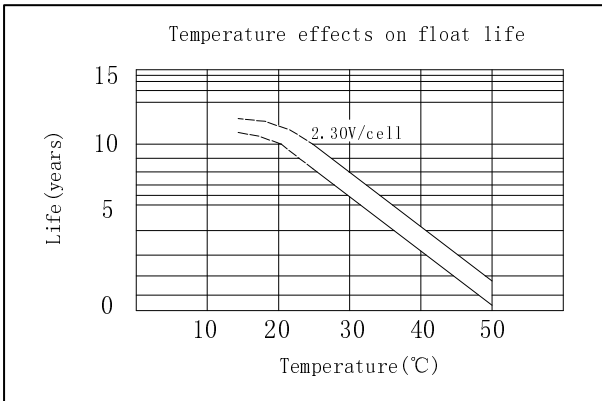
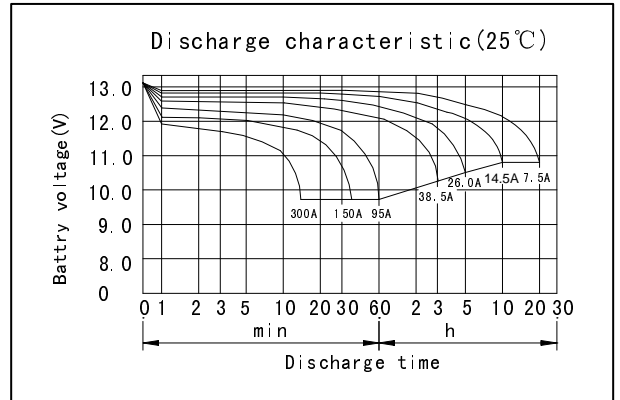
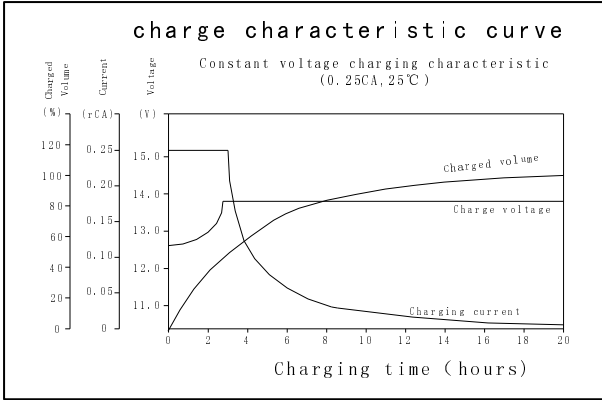

## GREAT POWER BATTERY TECHNOLOGY CO.,LTD

Address: Longguan 1st Road, LongHua Town, BaoAn District, Shenzhen, China.

TEL: 86-755-2900 8403 Fax: 86-755-3386 3366

Email: info@greatpowerbattery.com Http:// www.greatpowerbattery.com

