

The rechargeable batteries are lead-lead dioxide systems. The dilute sulfuric acid electrolyte is absorbed by separators and plates and thus immobilized. Should the battery be accidentally overcharged producing hydrogen and oxygen, special oneway valves allow the gases to escape thus avoiding excessive pressure build-up. Otherwise, the battery is completely sealed and is, therefore, maintenance-free, leak proof and usable in any position.



GENERAL FEATURES

- Absorbent Glass Mat (AGM) technology for efficient gas recombination of up to 99% and freedom from electrolyte for air transport-complies with LATA/ICAO Special provision A67.
- Not restricted for air transport-complies with LATA/ICAO Special Provision A67.
- UL-recognized component.
- Can be mounted in any orientation.
- Computer designed lead, calcium tin alloy grid for high power density.
- Long service life, float or cyclic applications.
- Maintenance-free operation.
- Low self discharge.
- Case and cover available in both standard and flame retardant ABS.

SPECIFICATION

Nominal voltage	12V	Dimensions	Total Height	12.5inches(317mm)
Rated capacity (10 hour rate)	125Ah		Height	12.5inches(317mm)
Number of cell	6		Length	17.2inches(436mm)
Approx. Weight (Kg / Lbs)	39.5/87.1		Width	4.25inches(108mm)

Battery Dimensions

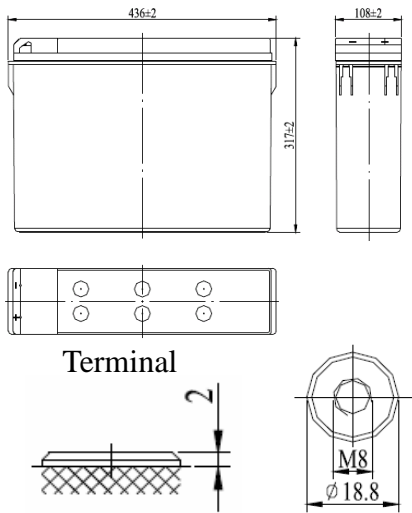

Constant power discharge ratings-watts per cell at 25°C(77 F)

End Point Volts/Cell	5min	10min	15min	30min	45min	1h	2h	3h	5h
1.60V		450	376	252	192	157	90.8	66.1	44.2
1.65V		428	361	246	188	154	89.3	65.4	43.9
1.70V		406	347	239	184	150	87.9	64.7	43.6
1.75V		383	333	232	179	147	86.4	63.9	43.2
1.80V		361	318	225	175	144	85.0	63.2	42.9

Characteristic

Capacity 77° F(25°C)	20 hour rate (6.6A、10.5V)	132Ah
	10 hour rate (12.5A、10.5V)	125Ah
	5 hour rate (21.3A、10.5V)	107Ah
	1 hour rate (75 A、9.6V)	75Ah
	1C (125A、9.6V)	32min
	3C (375A、9.6V)	7min
Internal Resistance	Full charged Battery77° F(25°C) : 5m Ω	
Capacity affected by Temperature (20 hour rate)	104° F(40°C)	102%
	77° F(25°C)	100%
	32° F(10°C)	85%
	5° F(-15°C)	65%
Self-Discharge 68° F(20°C)	Capacity after 3 month storage	90%
	Capacity after 6 month storage	80%
	Capacity after 12month storage	60%
Max. discharge current77° F(25°C) : 900A(5S)		
Charge (Constant Voltage)	Float: 13.6~13.8 V/77° F/(25°C)	
	Cycle: 14.5~14.9 V/77° F/(25°C) Max. Current: 31.3A	

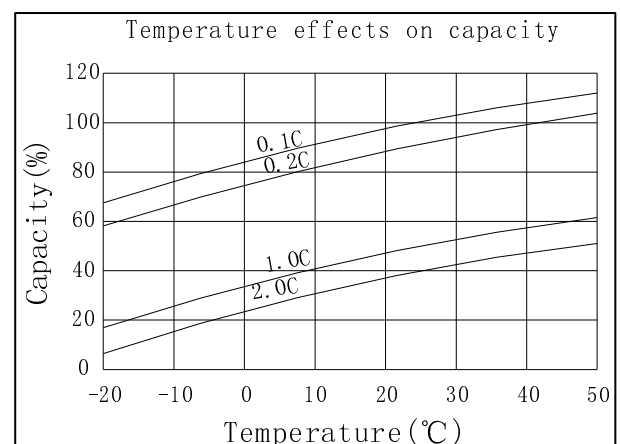
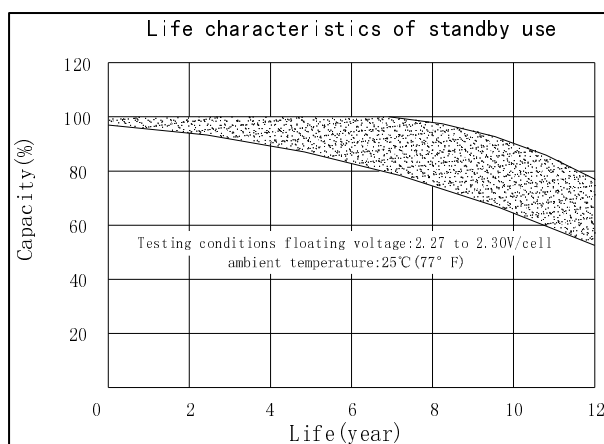
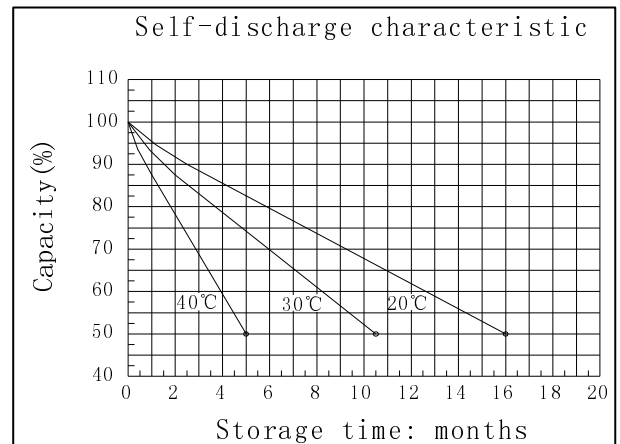
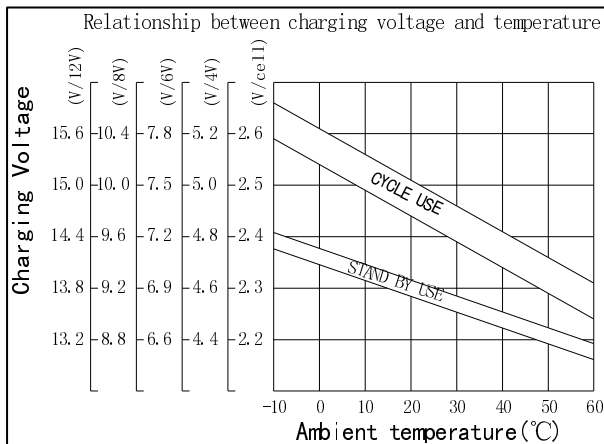
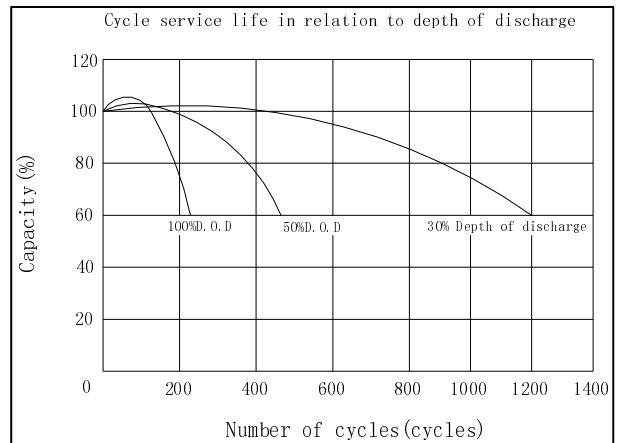
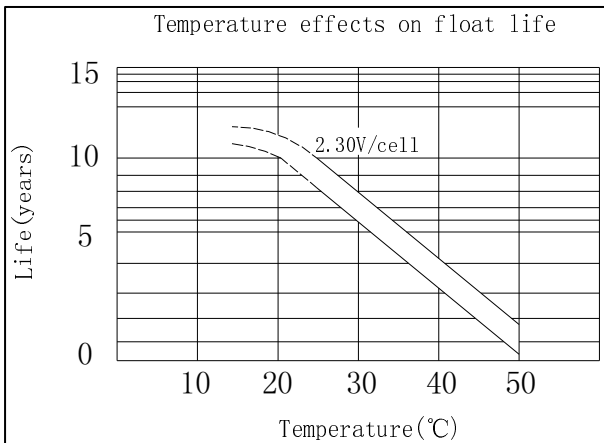
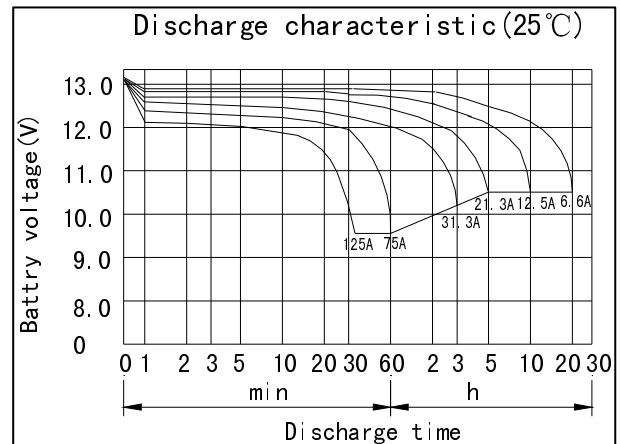
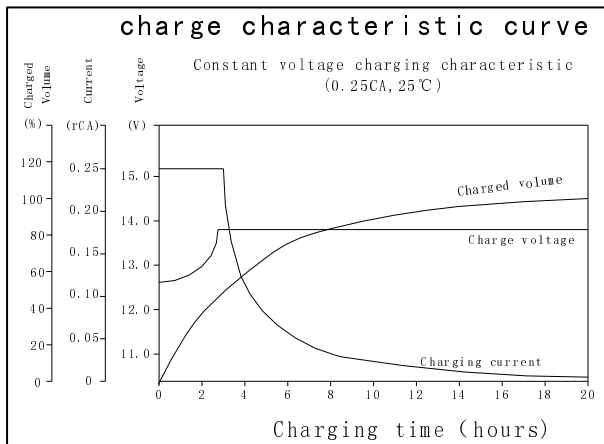

GREAT POWER BATTERY TECHNOLOGY CO.,LTD

Address: Longguan 1st Road, LongHua Town, BaoAn District, Shenzhen, China.

TEL: 86-755-2900 8403 Fax: 86-755-3386 3366

Email: info@greatpowerbattery.com Http:// www.greatpowerbattery.com